



## OVERVIEW

**AC1000** is an big size Enterprise Gateway based on **CAPWAP** protocol. Support Load Balance, Ethernet backup and Ethernet Superimposed, multi-ISP access; then support DHCP, policy routing and VPN, together with Smart flow control, Abundant security, varied user management and multiple authentication function, it consistent to provide high efficiency and professional network connectivity for hotel, school, hospital, shopping mall. What's more, it can manage the wireless access point fast and stable in central and remote, provide whole wireless coverage solution, cost saved and convenient.

### Main Features:

#### 1. Multiple Gigabit WAN and multiple routing functions

**AC1000** support PPPoE/DHCP/Static IP access, work with different ISP and max **1000** end users can access into it.

Support multiple Gigabit WAN ports, support load balance, Ethernet Superimposed and multiple ISP network access to avoid bandwidth overload, then support Ethernet backup to recover the dropped networking line, ensure the whole networking smoothly;

It support policy-based routing function also, administrator will set the network based on IP/MAC/Domain/Interface policies.

#### 2. Smart QoS

**AC1000** support smart QoS based on ports, individual users, user groups and user applications. Allow bandwidth reservation and dispatch by tunnel or by application.

It provide a variety of functions including multiple queuing mechanisms (priority queuing, low latency queuing, custom queuing, weighted queuing), congestion avoidance, traffic policing, traffic shaping and priority marking, ensuring different service for different users and applications.

#### 3. Abundant security mechanism

**AC1000** support a variety of security mechanism, like TCP/UDP/ICMP Flooding, IP/MAC/URL/Web filtering functions, Ping of Death and other related threats, extend protection to every port of the router and enable the ports to provide DoS/DDoS attack protection, traffic monitoring, Uniform Resource Locator (URL) filtering, and application layer filtering.

What's more, it support user management and password protection. Users of different levels are assigned with different configuration authorities.

#### 4. Multiple authentication

**AC1000** support portal authentication, PPPoE authentication and Radius authentication

It support Wechat authentication, one-time password authentication, display or promote advertisement to user and bring extra value for merchant; Then support SMS authentication when access into cloud server and work with SMS gateway.

Then it can work with the 3<sup>rd</sup> party radius server for advertisement and billing functions.

What's more, it work as PPPoE server, can create PPPoE account, password, bandwidth and valid time, to realize PPPoE billing function.

## 5.Remote Maintenance, Auto firmware upgrade

Administrator can access into **AC1000's** management interface page remotely at home, to manage and maintenance the wireless access point, keep the whole network stable in economic way.

**AC1000** can automatically to upgrade the new released firmware, zero steps to recovery the system problem.

## 6.Others

**AC1000** support WAN Port VLAN, VPN dial up, DNS Proxy, IP address translation, user behavior management, make it more professional in Enterprise.

## 7.AC management for wireless AP

**Assign IP address for Wireless AP:** Build in DHCP Server, it can assign the IP address for wireless AP automatically when AP online.

**Group or Single Configure:** **AC1000** auto detect the wireless AP, support group or single configuration, central to manage the SSID password, mode, channel, RF power, coverage threshold; Then reboot, reset or upgrade firmware remotely to complete the maintenance.

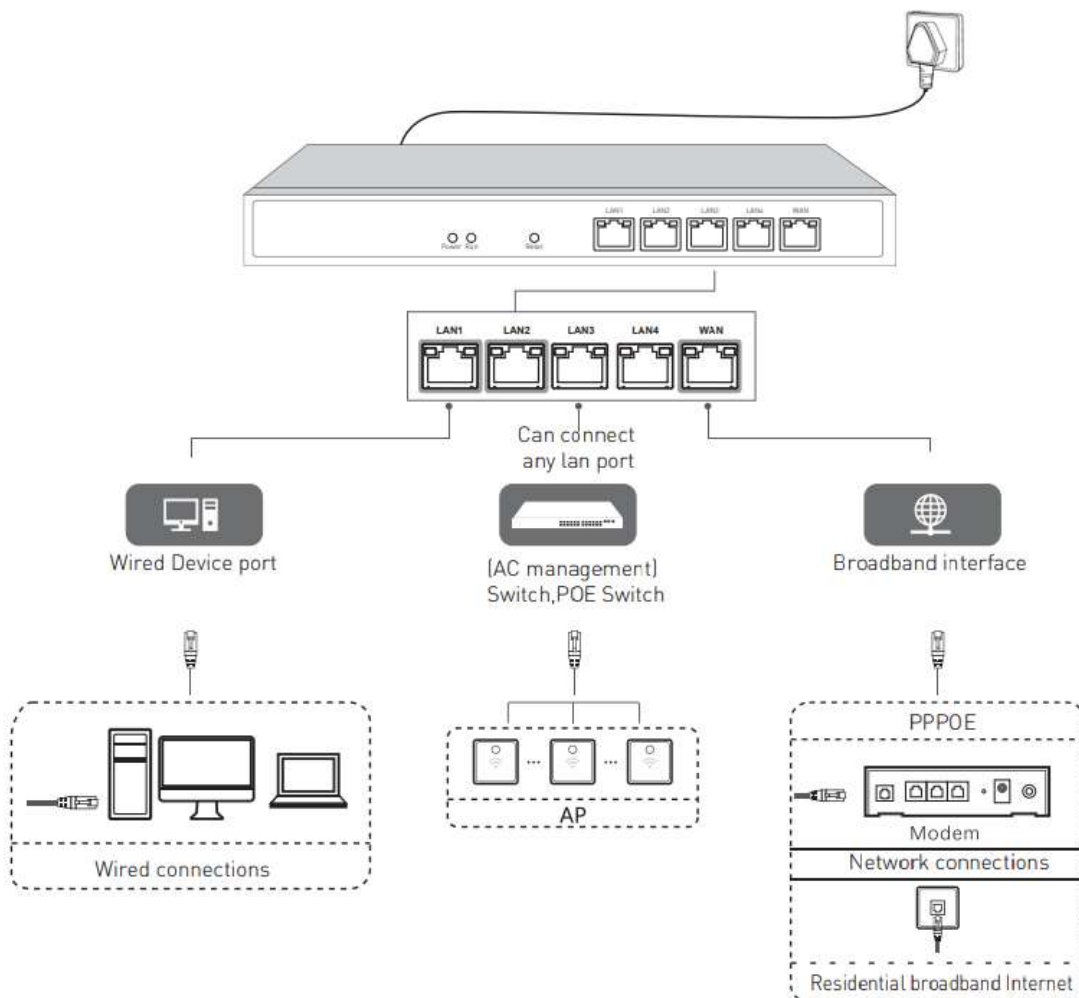

## TECHNICAL SPECIFICATION

<b>Model</b>	<b>AC1000</b>
<b>Protocol</b>	IEEE 802.3, 802.3u, 802.3ab TCP/IP, DHCP, ICMP, NAT, PPPoE, SNTP, HTTP, DDNS, IPsec, PPTP, L2TP, CAPWAP Protocol
<b>CPU</b>	Intel core i3
<b>DDR</b>	2GB (Kingston)
<b>SSD</b>	32GB
<b>Heat Dissipate</b>	Super silent ball fan
<b>Ports</b>	5 x 10/100/1000Mbps LAN ports (can set to WAN port)
	1 x 10/100/1000Mbps WAN port
	2 x USB2.0 Ports
	1 x Console Port
<b>Power</b>	AC:100-240V,50HZ
<b>Dimension</b>	440mm*240mm*44mm
<b>Working Temperature</b>	-20°C~55°C
<b>Storage Temperature</b>	-40°C ~ 70°C
<b>Working Humidity</b>	5% ~ 97%RH (No condensation)
<b>Firmware features</b>	
<b>AP Management</b>	Max to access and manage <b>1000</b> users
	Max to manage <b>512PCS</b> wireless AP
	Centrally and remotely to manage/configure wireless AP
	View user's status
<b>Smart Flow Control</b>	One click smart flow control
	Powerful multiline diversion
	Application Priority Automatically
<b>Load Balance</b>	Multiple WAN, multiple ISP network access
	Intelligence load balance
	Ethernet line backup
	Ethernet Superimposed
	Policy routing: based on IP address, destination IP address, source MAC address, network port, domain, destination port, Extranet port, Identity binding
	Protocol binding
<b>Routing</b>	Static Routing
<b>Behavior Management</b>	All-round to block P2P firmware
	P2P flow control and bandwidth allot
	File and URL filter
	Monitor network behavior at all times
<b>Bandwidth limitation</b>	IP-based bandwidth limitation

	Safeguard / Restrict bandwidth
	Time strategy
	IP based session restriction
<b>Security Center</b>	MAC address filter
	UPR/key words filter
	Web content filter
	IP address filter
	Port mapping
	DMZ
<b>Defense Center</b>	TCP/UDP/ICMP flood defense
	Block TCP scanning
	Block ping WAN port
<b>ARP Detection</b>	Send GARP packets
	ARP Scanning on WAN/LAN port
	Online detection
	IP-MAC binding
<b>Authentication</b>	PPPoE authentication
	Portal authentication like Wechat Authentication, WEB password authentication, One-time password authentication, SMS authentication
	Radius authentication: work with the 3rd party radius server
<b>Management</b>	Web/CLI/Telnet management
	Remote management
<b>Others</b>	DDNS, VPN management

## ORDERING INFORMATION

Model	Description
AC1000	AC1000 Enterprise Load Balance Gateway WLAN Controller

## PACKAGE CONTENT

QTY	UNIT	CONTENT
1	SET	AC1000 Enterprise Load Balance Gateway WLAN Controller
1	SET	Power Cable
1	PC	Quick Install Guide
1	PC	Warranty Card