



# USER GUIDE



EZ Switch™

16/24-Port Fast Ethernet Switch

**SMCFS1601/SMCFS2401**

## COPYRIGHT & TRADEMARKS

Specifications are subject to change without notice.  is a registered trademark of SMC TECHNOLOGIES CO, LTD. Other brands and product names are trademarks or registered trademarks of their respective holders.

No part of the specifications may be reproduced in any form or by any means or used to make any derivative such as translation, transformation, or adaptation without permission from SMC TECHNOLOGIES CO, LTD. Copyright © 2010 SMC TECHNOLOGIES CO, LTD. All rights reserved.

<http://www.smc.com>

## FCC STATEMENT



This equipment has been tested and found to comply with the limits for a Class A digital device, pursuant to part 15 of the FCC Rules. These limits are designed to provide reasonable protection against harmful interference when the equipment is operated in a commercial environment. This equipment generates, uses, and can radiate radio frequency energy and, if not installed and used in accordance with the instruction manual, may cause harmful interference to radio communications. Operation of this equipment in a residential area is likely to cause harmful interference in which case the user will be required to correct the interference at his own expense.

This device complies with part 15 of the FCC Rules. Operation is subject to the following two conditions:

- 1) This device may not cause harmful interference.
- 2) This device must accept any interference received, including interference that may cause undesired operation.

Any changes or modifications not expressly approved by the party responsible for compliance could void the user's authority to operate the equipment.

## CE Mark Warning



This is a class A product. In a domestic environment, this product may cause radio interference, in which case the user may be required to take adequate measures.

# CONTENTS

<b>Package Contents</b> .....	<b>1</b>
<b>Chapter 1 Product Introduction</b> .....	<b>2</b>
1.1 Product Overview .....	2
1.2 Features .....	2
<b>Chapter 2 Identifying External Components</b> .....	<b>2</b>
2.1 Front Panel .....	3
2.2 Rear Panel.....	3
<b>Chapter 3 Installation</b> .....	<b>4</b>
3.1 Precautions.....	4
3.2 Installation.....	5
3.2.1 Desktop Installation .....	5
3.2.2 Rack Installation.....	6
3.3 Connect to Ground .....	7
3.4 Power on .....	8
<b>Appendix A: Specifications</b> .....	<b>9</b>
<b>Appendix B: Troubleshooting</b> .....	<b>10</b>

# Package Contents

The following contents should be found in your package:

- One SMCFS1601 /SMCFS2401 Switch
- One power cord
- This User Guide
- Mounting screws and two “L” planks
- Quick Installation Guide
- SMC Warranty Card
- Four rubber foot pads



**Note:**

Make sure that the package contains the above items. If any of the listed items are damaged or missing, please contact with your distributor.

---

## Chapter 1 Product Introduction

This chapter describes the features of the model of SMCFS1601/SMCFS2401 16/24-Port 10/100Mbps Fast Ethernet Switch.

### 1.1 Product Overview

SMCFS1601/SMCFS2401 Switch provides 16/24-Port 10/100Mbps Auto-Negotiation RJ45 ports. Each port of the SMCFS1601/SMCFS2401 supports auto MDI/MDI-X function, eliminating the need for crossover cables or Uplink ports. The Switch is Plug- and-Play and any port can be simply plugged into a server, a hub or a switch, using straight cable or crossover cable.

The SMCFS1601/SMCFS2401 16/24-port 10/100Mbps Fast Ethernet Switch provides you with a low-cost, easy-to-use, high-performance, seamless and standard upgrade to improve your old network to a 100Mbps network. It will boost your network performance up to full duplex data transfer.

### 1.2 Features

- Complies with IEEE802.3, IEEE802.3u standards
- 16/24 10/100Mbps Auto-Negotiation RJ45 ports supporting Auto- MDI/MDIX
- Supports IEEE802.3X flow control for full-duplex mode and backpressure for half-duplex mode
- LED indicators for monitoring power, link, activity, speed
- Rack-mountable steel case
- Internal power supply

## Chapter 2 Identifying External Components

This Chapter describes the front panel, rear panel and LED indicators of the Switch. SMCFS1601/SMCFS2401 just differ in the number of LED indicators and ports, and all figures in this guide are of SMCFS2401.

## 2.1 Front Panel

The front panel of SMCFS2401 consists of switch model, switch LED indicators, and 24 10/100Mbps RJ-45 ports.

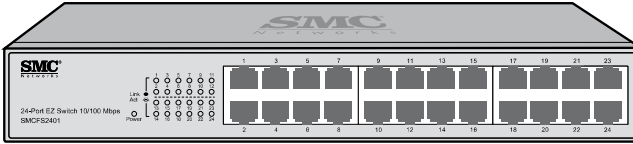

Figure 2-1 SMCFS2401 Switch Front Panel sketch

The LED indicators include Power, Link/Act LED indicators, which are used for monitoring and pre-troubleshooting of the Switch. The following section shows the LED indicators of the Switch along with an explanation of each indicator.

- **Power LED:** This indicator will light solid green when the Switch powers up. If the LED is not lit, please check the power supply and connection.
- **Link/Act LED:** The LED indicates Link/Active status. The corresponding LED indicator will light solid green when connected to a network device. It flashes green when data is being transmitted or received on the working connection.

## 2.2 Rear Panel

The rear panel of SMCFS2401 features a power socket and a Grounding Terminal (marked with ⊕).

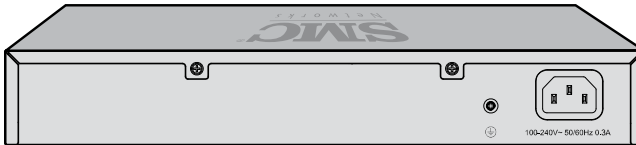

Figure 2-2 SMCFS2401 Switch Rear Panel sketch

- **Grounding Terminal:** SMCFS1601/SMCFS2401 already comes with Lightning Protection Mechanism. You can also ground the Switch through the PE (Protecting Earth) cable of AC cord or with Ground Cable. For detail information, please refer to section **3.3 Connect to Ground**.
- **AC Power Socket:** Connect the female connector of the power cord here, and the male connector to the AC power outlet. Please make sure the voltage of the power supply meets the requirement of the input voltage.

## Chapter 3 Installation

### 3.1 Precautions

To ensure a long-term and stable performance of the Switch, please pay attention to the following before the installation.

#### 1) Safety Requirements

- Before cleaning the Switch, cut off the power supply. Do not clean it by the waterish cloth, and never use any other liquid cleaning method.
- Take waterproof measures during storage, transportation and operation of the equipment.
- Use only the power cord provided with the Switch.
- Make sure the voltage of the power supply meets the requirement of the input voltage of the Switch.
- Do not push any objects into the openings of the Switch.
- Ensure the vent hole is well ventilated and unblocked.
- Do not open or remove the cover of the Switch.

#### 2) Location Requirements

When you choose a location for the Switch, please follow these guidelines:

- Install the Switch on a flat and stable surface that can support the entire weight of the Switch with all fittings.
- Locate the Switch far from strong electromagnetic field generators (such as motors), vibration, dust, and direct exposure to sunlight.
- To ensure adequate air flow around the Switch. At least 10 cm (4 inches) of space at the front and rear of the Switch is needed for ventilation.
- Make sure that the Switch will be accessible and that the cables can be easily connected.
- Position the Switch away from water and moisture sources, be sure to provide an acceptable temperature and humidity operating environment.

## 3.2 Installation

This Switch can be either installed on the standard 19-inch mountable rack or located on the desktop.



### Caution:

Please unplug the power cord before installing or removing the Switch.

---

### 3.2.1 Desktop Installation

To install the Switch on the desktop, please follow the steps:

- 1) Set the Switch on a flat surface strong enough to support the entire weight of the Switch with all fittings.
- 2) Remove the adhesive backing papers from the rubber feet.
- 3) Turnover the Switch and attach the supplied rubber feet to the recessed areas on the bottom at each corner of the Switch.

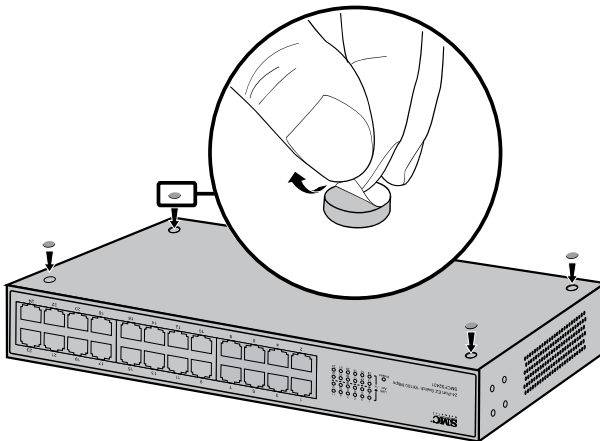

Figure 3-1 Attaching Rubber Feet

- 4) Uprun the Switch and connect it to the network devices while keep enough ventilation space around.
- 5) Connect the Switch to power source with the provided power cord.



### Caution:

Please avoid any heavy thing placed on the Switch.

---



### 3.2.2 Rack Installation

To install the Switch in an EIA standard-sized, 19-inch rack, follow the instructions described below:

- 1) Secure the supplied rack-mounting brackets to each side of the Switch with supplied screws, as illustrated in the following figure.

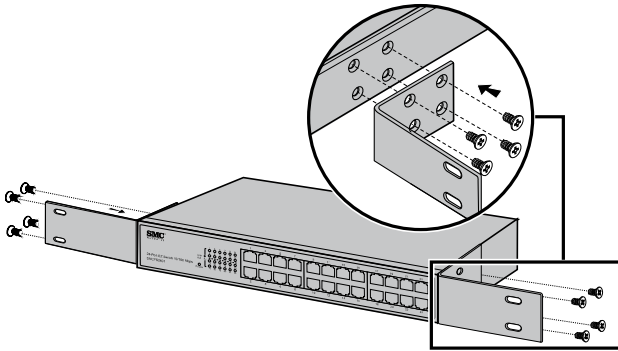

Figure 3-2 Attaching Brackets

- 2) After the brackets are attached to the Switch, use suitable screws (not provided) to secure the brackets to the rack, as illustrated in the following figure.

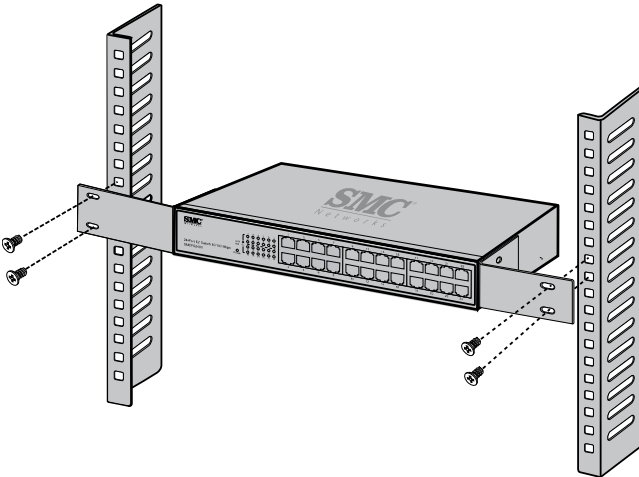

Figure 3-3 Mounting Switch

- 3) Connect the Switch to network devices.
- 4) Supply power to the Switch with the provided power cord.

### 3.3 Connect to Ground

Connecting the Switch to ground is to quickly release the lightning over-voltage and over-current of the Switch, which is also a necessary measure to protect the body from electric shock.

In different environments, the Switch may be grounded differently. The following will instruct you to connect the Switch to the ground in two ways, connecting to the Grounding Bar or connecting to the Ground via the power cord. Please connect the Switch to ground in the optimum way according to your specific operation environment.

- **Connecting to the Grounding Bar**

If the Switch is installed in the Equipment Room, where a Grounding Bar is available, you are recommended to connect the Switch to the Grounding Bar as shown in the following figure.

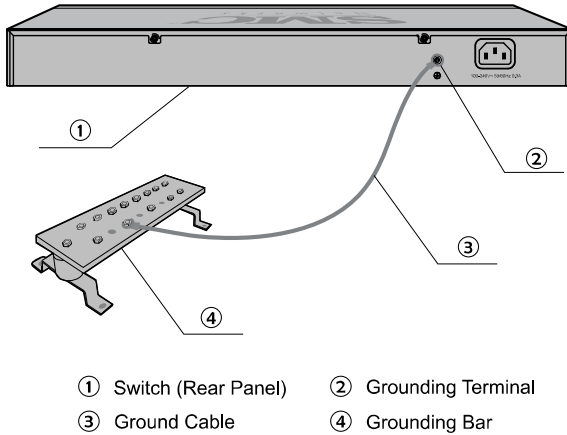

Figure 3-4



**Note:**

The Grounding Bar and Ground Cable are not provided with our product.

- **Connecting to the Ground via the power supply**

If the Switch is installed in the normal environment, the Switch can be grounded via the PE (Protecting Earth) cable of the AC power supply as shown in the following figure.

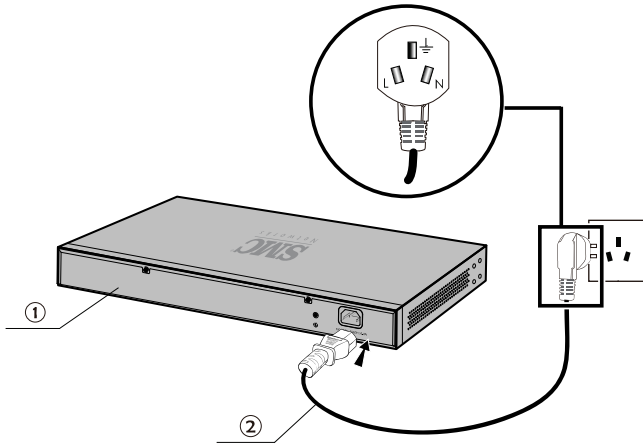

Figure 3-5

\* The figure is to illustrate the application and principle. The power plug you get from the package and the socket in your situation will comply with the regulation in your country, so they may differ from the figure above.



**Note:**

If you intend to connect the Switch to the ground via the PE (Protecting Earth) cable of AC power cord, please make sure the PE (Protecting Earth) cable in the electrical outlet is well grounded in advance.

### 3.4 Power on

The SMCFS1601/SMCFS2401 16/24-port 10/100Mbps Fast Ethernet Switch is powered by an AC Power Supply. Connect the Switch and power outlet by power cord. Powering on the Switch, it will be automatically initialized and the LED indicators should respond as follows:

- 1) All of the LED indicators will flash momentarily for one second, which represents a resetting of the system.
- 2) The Power LED indicator will light up.

## Appendix A: Specifications

General	
Standards	IEEE 802.3 10Base-T, IEEE 802.3u 100Base-TX
Topology	Star
Protocol	CSMA/CD
Data Transfer Rate	Ethernet: 10Mbps (Half Duplex) 20Mbps (Full Duplex)
	Fast Ethernet: 100Mbps (Half Duplex) 200Mbps (Full Duplex)
Network Media (Cable)	10Base-T: UTP category 3, 4, 5 cable (maximum 100m)
	EIA/TIA-568 100 STP (maximum 100m)
	100Base-TX: UTP category 5, 5e cable (maximum 100m)
	EIA/TIA-568 100 STP (maximum 100m)
Number of Ports	16/2410/100Mbps Auto-Negotiation RJ-45 ports
Safety & Emissions	FCC, CE
LED indicators	Power, Link/Act
Transfer Method	Store-and-Forward
MAC Address Learning	Automatically learning, automatically aging
Frame Filter Rate	10Base-T: 14881pps/Port
	100Base-Tx: 148810pps/Port
Frame Forward Rate	10Base-T: 14881pps/Port
	100Base-Tx: 148810pps/Port

Environmental and Physical	
Operating Temperature	0°C ~40°C
Storage Temperature	-40°C ~70°C
Operating Humidity	10%~90% non-condensing
Storage Humidity	5%~90% non-condensing

## **Appendix B: Troubleshooting**

### **1. The Power LED is not lit**

- Make sure the AC power cord connected the Switch with power source properly.
- Make sure the power source is ON.

### **2. The Link/Act LED is not lit when a device is connected to the corresponding port**

- Make sure that the cable connectors are firmly plugged into the Switch and the device.
- Make sure the connected device is turned on and working well.
- The cable must be less than 100 meters long (328 feet).

**SMIC<sup>®</sup>**

---

N e t w o r k s

## TECHNICAL SUPPORT

From U.S.A. and Canada (24 hours a day, 7 days a week)  
Phn: (800) SMC-4-YOU / (949) 679-8000  
Fax: (949) 679-1481

**English:** Technical Support information available at [www.smc.com](http://www.smc.com)

**English(For Asia Pacific):** Technical Support information available at [www.smc-asia.com](http://www.smc-asia.com)

**Deutsch:** Technischer Support und weitere Information unter [www.smc.com](http://www.smc.com)

**Español:** En [www.smc.com](http://www.smc.com) Ud. podrá encontrar la información relativa a servicios de soporte técnico

**Français:** Informations Support Technique sur [www.smc.com](http://www.smc.com)

**Português:** Informações sobre Suporte Técnico em [www.smc.com](http://www.smc.com)

**Italiano:** Le informazioni di supporto tecnico sono disponibili su [www.smc.com](http://www.smc.com)

**Svenska:** Information om Teknisk Support finns tillgängligt på [www.smc.com](http://www.smc.com)

**Nederlands:** Technische ondersteuningsinformatie beschikbaar op [www.smc.com](http://www.smc.com)

**Polski:** Informacje o wsparciu technicznym są dostępne na [www.smc.com](http://www.smc.com)

**Čeština:** Technická podpora je dostupná na [www.smc.com](http://www.smc.com)

**Magyar:** Műszaki támogatás információ elérhető -on [www.smc.com](http://www.smc.com)

**简体中文:** 技术支持讯息可通过[www.smc-prc.com](http://www.smc-prc.com)查询

**繁體中文:** 產品技術支援與服務請上 [www.smcnetworks.com.tw](http://www.smcnetworks.com.tw)

**ไทย:** สามารถหาข้อมูลทางด้านเทคนิคได้ที่ [www.smc-asia.com](http://www.smc-asia.com)

**한국어:** 기술지원관련 정보는 [www.smc-asia.com](http://www.smc-asia.com)을 참고하시기 바랍니다

## INTERNET

E-mail address: [www.smc.com](http://www.smc.com) → Support → By email  
Driver updates: [www.smc.com](http://www.smc.com) → Support → Downloads

World Wide Web: <http://www.smc.com/>

# SMCFS1601/SMCFS2401